

WORK AREA 03
RATHMULLAN ABBEY

LEGEND

- SITE SUBJECT TO THIS PART 8 PLANNING APPLICATION
- OUTLINED IN RED
- WORK AREA

AREA OF DEVELOPMENT SITE: 1.26 Hectares
 OS MAP NO. DL 37 , DL 0146-C
 ITM COORDS: 629742, 927519

Reproduced under License by the Government
 Ordnance Survey Ireland License No. 2020/ISO_NIMA_053
 Ordnance Survey Ireland and Government of Ireland

This drawing has been prepared for the purposes of obtaining Part 8 consent only, for fire certification, tender, compliance with building regulations, construction, or any other purpose, please refer to appropriate labeled drawings.

WORK AREA 03 _ RATHMULLAN ABBEY
SITE PLAN



Community Development & Planning Services
Regeneration & Development Team

Three Rivers Centre, Lifford, Co Donegal

Tel:(074)9153900 Fax:(074)9141793 www.donegalcoco.ie

L. Ward, Director of Community Development & Planning Services



LEAD CONSULTANT / ARCHITECT	ROBIN LEE ARCHITECTURE
ARCHITECT	PASPARAKIS FRIEL
CONSERVATION ARCHITECT	DONALD INSALL ASSOCIATES
LANDSCAPE ARCHITECT	BERNARD SEYMOUR LANDSCAPE ARCHITECTS
QUANTITY SURVEYOR	SAMMON
STRUCTURAL ENGINEER	CORA
MECHANICAL & ELECTRICAL ENGINEER	DELAP & WALLER
ECOLOGIST	GREENTRACK
FIRE ENGINEER & ACCESSIBILITY	AFEC

Status Key

SL	Survey
SK	Sketch Design
INFO	Information
PL	Planning - Part 8
DD	Detailed Design
FSC	Fire Safety Cert.
DAC	Dis. Acc. Cert.
T	Tender
C	Construction
CPO	CPD
SP	Safety File
O	Other

Rev	Date	Description	Issued by
-	01.11.22	PART 8 APPLICATION	RLA

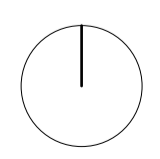

Project Title:	RATHMULLAN (COMMUNITY & HERITAGE) REGENERATION PROJECT	First Issue Date:	01.11.2022	Status:	PL
Location:	RATHMULLAN, CO. DONEGAL	Drawing No.:	D.RA.001	Revision:	-
Drawing Title:	SITE PLAN	Project No.:	21021		
Scale:	1:500 / A1	Drawn By:	OC	Checked By:	OC / RL
		Approved By:	RL		



© COPYRIGHT - THIS DRAWING IS PROTECTED BY COPYRIGHT AND IS THE PROPERTY OF DONEGAL COUNTY COUNCIL. IT MAY NOT BE USED, REPRODUCED OR DISCLOSED TO ANYONE WITHOUT THE PRIOR WRITTEN APPROVAL OF DONEGAL COUNTY COUNCIL.

IMPORTANT
 This drawing to be read in conjunction with the ARCHITECT'S DESIGN REPORT for description of the design approach and additional information in support of the proposals illustrated on this page.

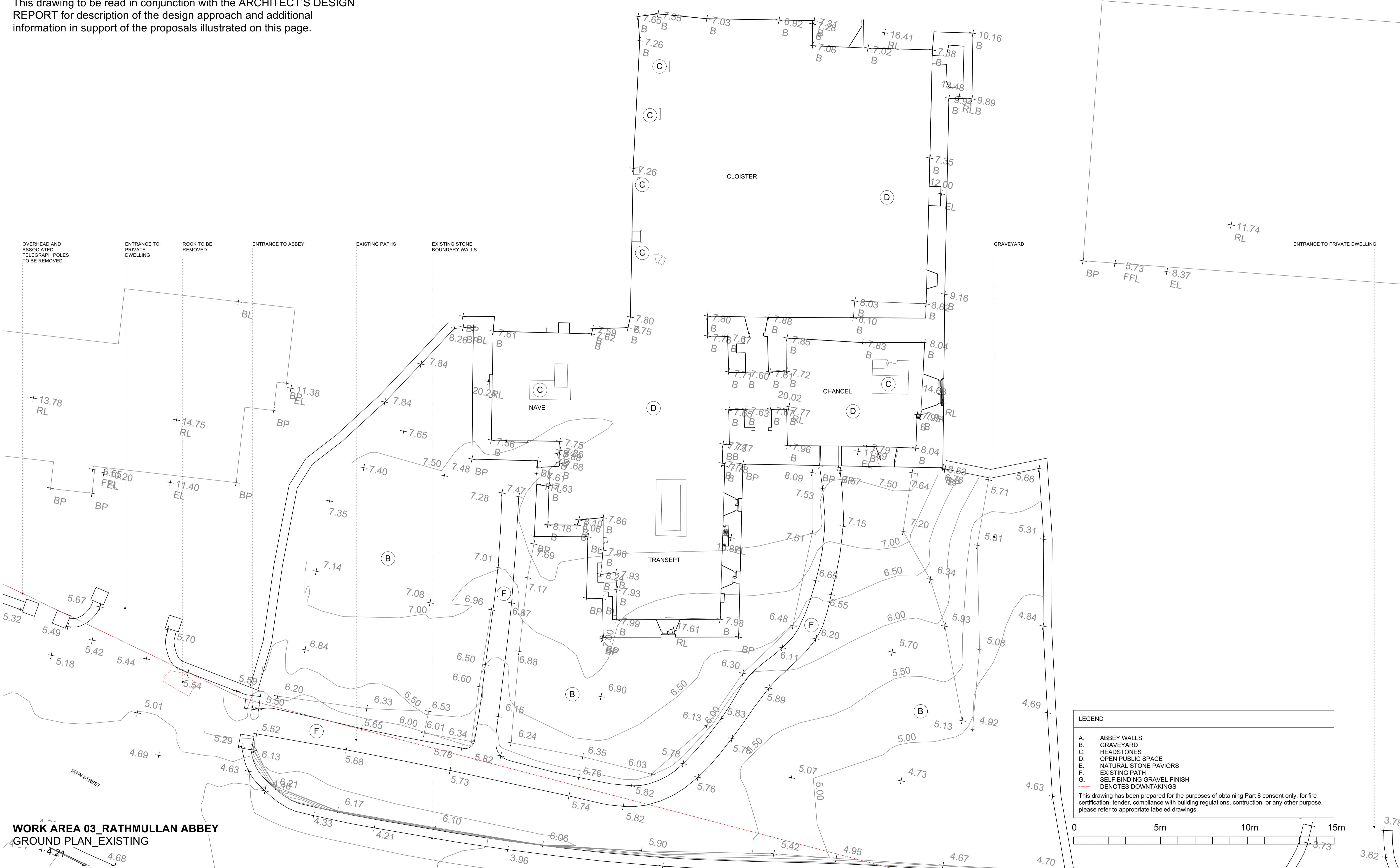

WORK AREA 03_RATHMULLAN ABBEY
 GROUND PLAN_EXISTING

LEGEND

- A. ABBEY WALLS
- B. GRAVEYARD
- C. HEADSTONES
- D. OPEN PUBLIC SPACE
- E. NATURAL STONE PAVIORS
- F. EXISTING PATH
- G. SELF BINDING GRAVEL FINISH
- DENOTES DOWNTAKINGS

This drawing has been prepared for the purposes of obtaining Part 8 consent only, for fire certification, tender, compliance with building regulations, construction, or any other purpose, please refer to appropriate labeled drawings.

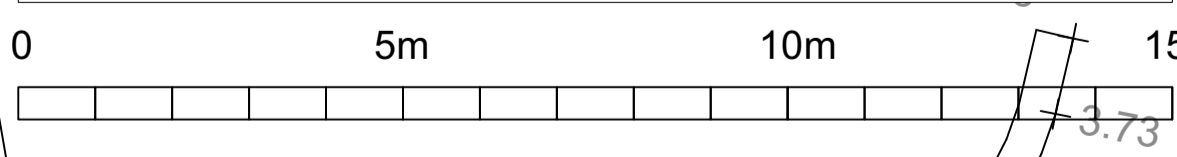

Community Development & Planning Services
 Regeneration & Development Team

Three Rivers Centre, Lifford, Co Donegal

Tel:(074)9153900 Fax:(074)9141793 www.donegalcoco.ie

L. Ward, Director of Community Development & Planning Services



LEAD CONSULTANT / ARCHITECT	ROBIN LEE ARCHITECTURE
ARCHITECT	PASPARAKIS FRIEL
CONSERVATION ARCHITECT	DONALD INSALL ASSOCIATES
LANDSCAPE ARCHITECT	BERNARD SEYMOUR LANDSCAPE ARCHITECTS
QUANTITY SURVEYOR	SAMMON
STRUCTURAL ENGINEER	CORA
MECHANICAL & ELECTRICAL ENGINEER	DELAP & WALLER
ECOLOGIST	GREENTRACK
FIRE ENGINEER & ACCESSIBILITY	APEC

Status Key

sk	Survey
sk	Sketch Design
info	Information
pl	Planning - Part 8
dd	Detailed Design
fsc	Fire Safety Cert.
mc	Dis. Acc. Cert.
t	Tender
c	Construction
cpo	CPO
sf	Safety File
o	Other

Rev	Date	Description	Issued by
-	01.11.22	PART 8 APPLICATION	RLA

Project Title:	RATHMULLAN (COMMUNITY & HERITAGE) REGENERATION PROJECT	First Issue Date:	01.11.2022	Status:	PL
Location:	RATHMULLAN, CO. DONEGAL	Drawing No.:	D.RA.010	Revision:	
Drawing Title:	RATHMULLAN ABBEY GROUND PLAN_EXISTING	Approved By:	SP	Project No.:	21021
Scale:	1:100 / A1	Checked By:	SP / RF		

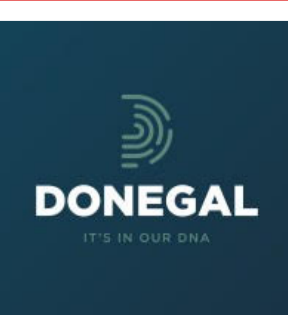

© COPYRIGHT - THIS DRAWING IS PROTECTED BY COPYRIGHT AND IS THE PROPERTY OF DONEGAL COUNTY COUNCIL. IT MAY NOT BE USED, REPRODUCED OR DISCLOSED TO ANYONE WITHOUT THE PRIOR WRITTEN APPROVAL OF DONEGAL COUNTY COUNCIL.

IMPORTANT
 This drawing to be read in conjunction with the ARCHITECT'S DESIGN REPORT for description of the design approach and additional information in support of the proposals illustrated on this page.

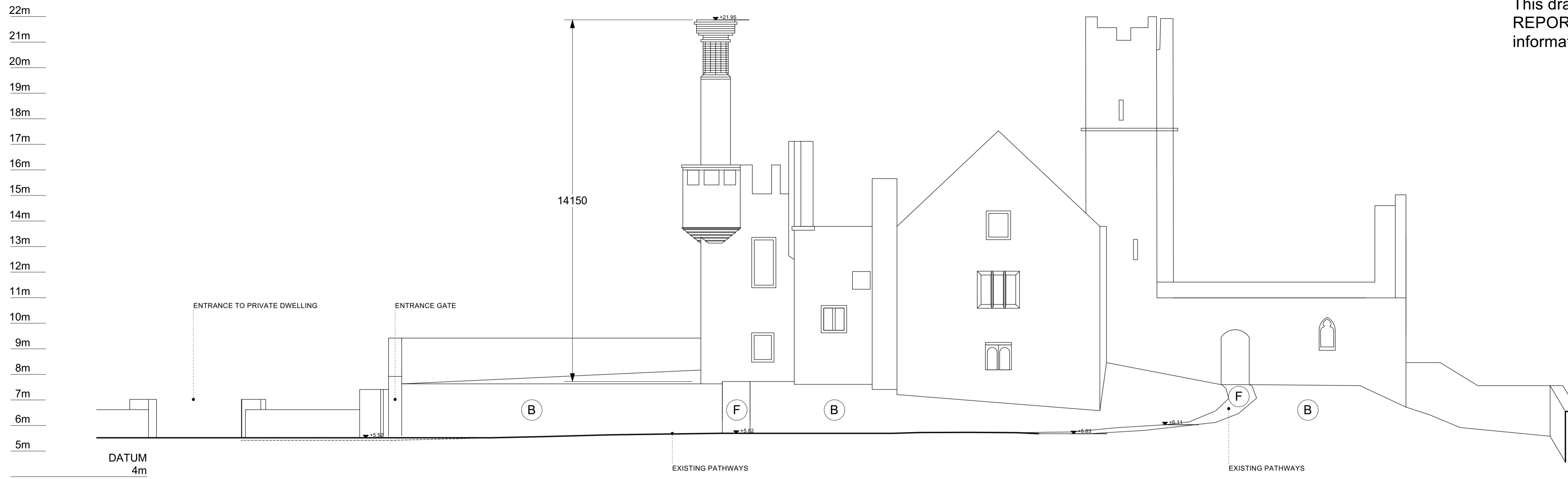

SECTION AA - EXISTING

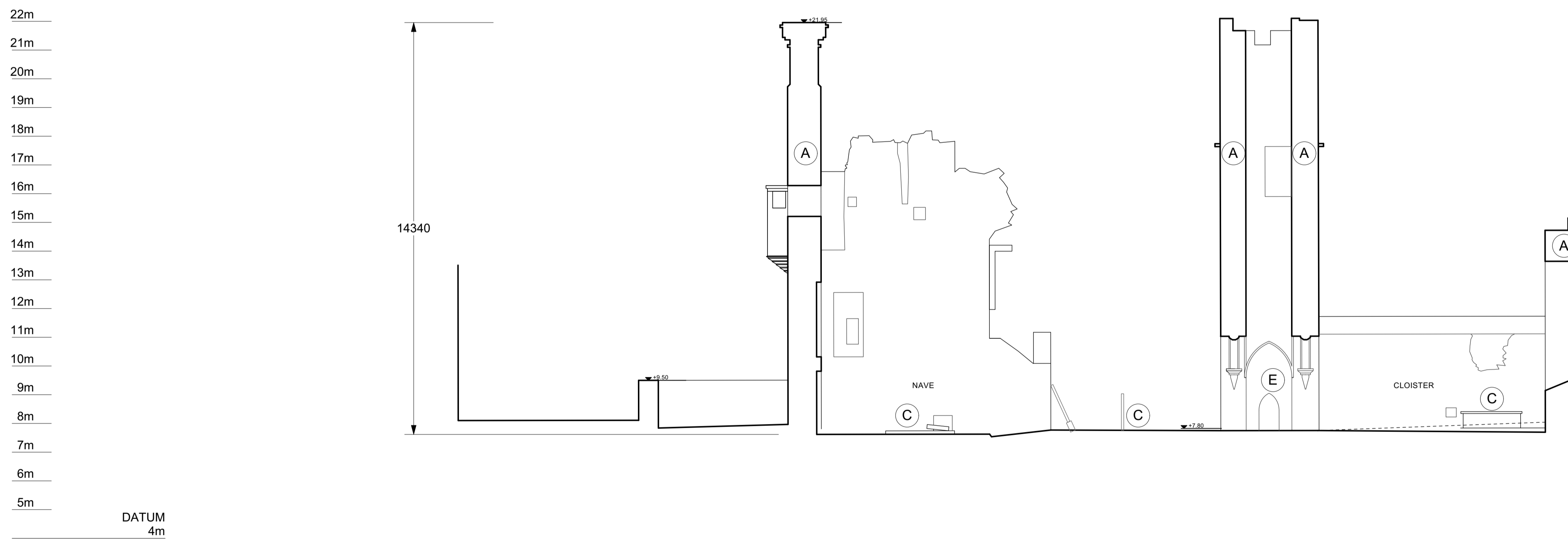

SECTION BB - EXISTING

WORK AREA 03_RATHMULLAN ABBEY
 EXISTING SECTIONS

LEGEND		
A.	ABBEY WALLS	
B.	GRAVEYARD	
C.	HEADSTONES	
D.	OPEN PUBLIC SPACE	
E.	NATURAL STONE PAVIORS	
F.	EXISTING PATH	
G.	SELF BINDING GRAVEL FINISH	

This drawing has been prepared for the purposes of obtaining Part 8 consent only, for fire certification, tender, compliance with building regulations, construction, or any other purpose, please refer to appropriate labeled drawings.

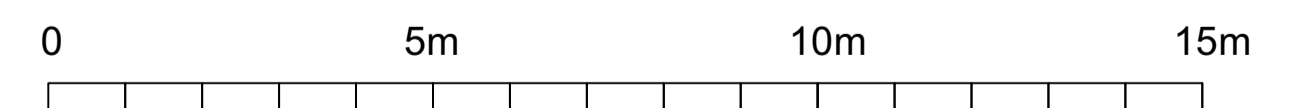

Community Development & Planning Services
 Regeneration & Development Team
 Three Rivers Centre, Lifford, Co Donegal
 Tel:(074)9153900 Fax:(074)9141793 www.donegalcoco.ie
 L. Ward, Director of Community Development & Planning Services



LEAD CONSULTANT / ARCHITECT	ROBIN LEE ARCHITECTURE
ARCHITECT	PASPARAKIS FRIEL
CONSERVATION ARCHITECT	DONALD INSALL ASSOCIATES
LANDSCAPE ARCHITECT	BERNARD SEYMOUR LANDSCAPE ARCHITECTS
QUANTITY SURVEYOR	SAMMON
STRUCTURAL ENGINEER	CORA
MECHANICAL & ELECTRICAL ENGINEER	DELAP & WALLER
ECOLOGIST	GREENTRACK
FIRE ENGINEER & ACCESSIBILITY	A FEC

Status Key	
SL	Survey
SK	Sketch Design
INFO	Information
PL	Planning - Part 8
DD	Detailed Design
FSC	Fire Safety Cert.
DAC	Dis. Acc. Cert.
T	Tender
C	Construction
CPO	CPO
SF	Safety File
O	Other

Rev	Date	Description	Issued by
-	01.11.22	PART 8 APPLICATION	RLA

Project Title:	RATHMULLAN (COMMUNITY & HERITAGE) REGENERATION PROJECT	First Issue Date:	01.11.2022	Status:	PL
Location:	RATHMULLAN, CO. DONEGAL	Drawing No.:	D.RA.011	Revision:	
Drawing Title:	RATHMULLAN ABBEY EXISTING SECTION AA/BB	Scale:	1:100 / A1	Drawn By:	RF
		Checked By:	SP / RF	Approved By:	SP
		Project No.:	21021		



22m
21m
20m
19m
18m
17m
16m
15m
14m
13m
12m
11m
10m
9m
8m
7m
6m
5m
4m
3m

IMPORTANT
This drawing to be read in conjunction with the ARCHITECT'S DESIGN REPORT for description of the design approach and additional information in support of the proposals illustrated on this page.

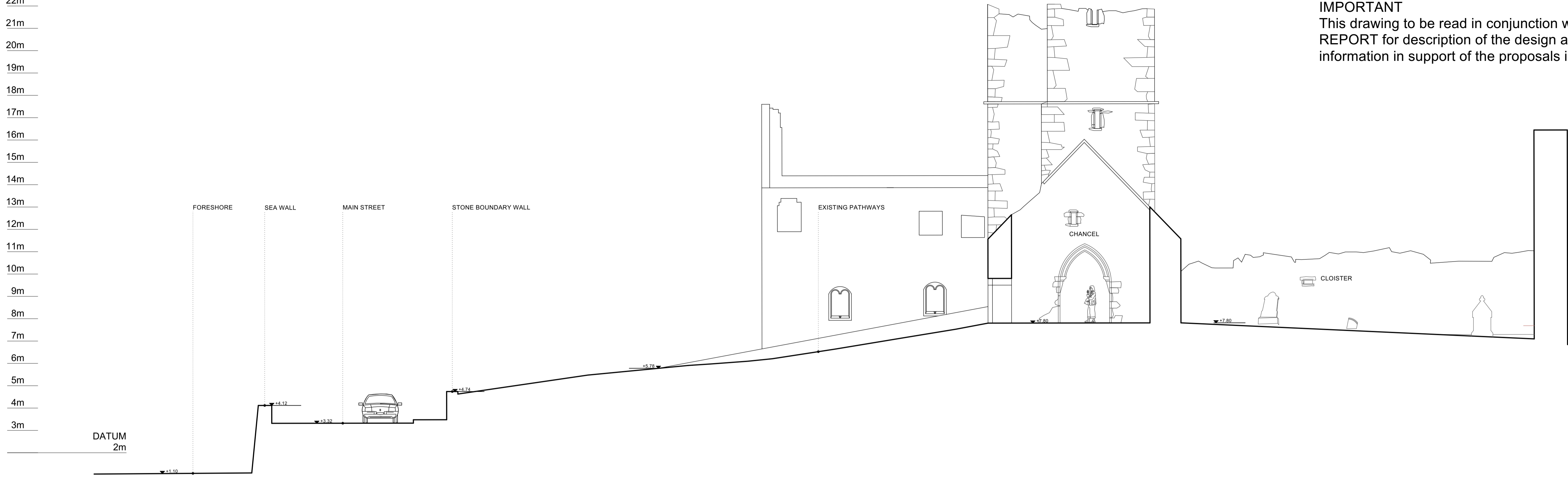

SECTION CC - EXISTING

22m
21m
20m
19m
18m
17m
16m
15m
14m
13m
12m
11m
10m
9m
8m
7m
6m
5m
4m
3m

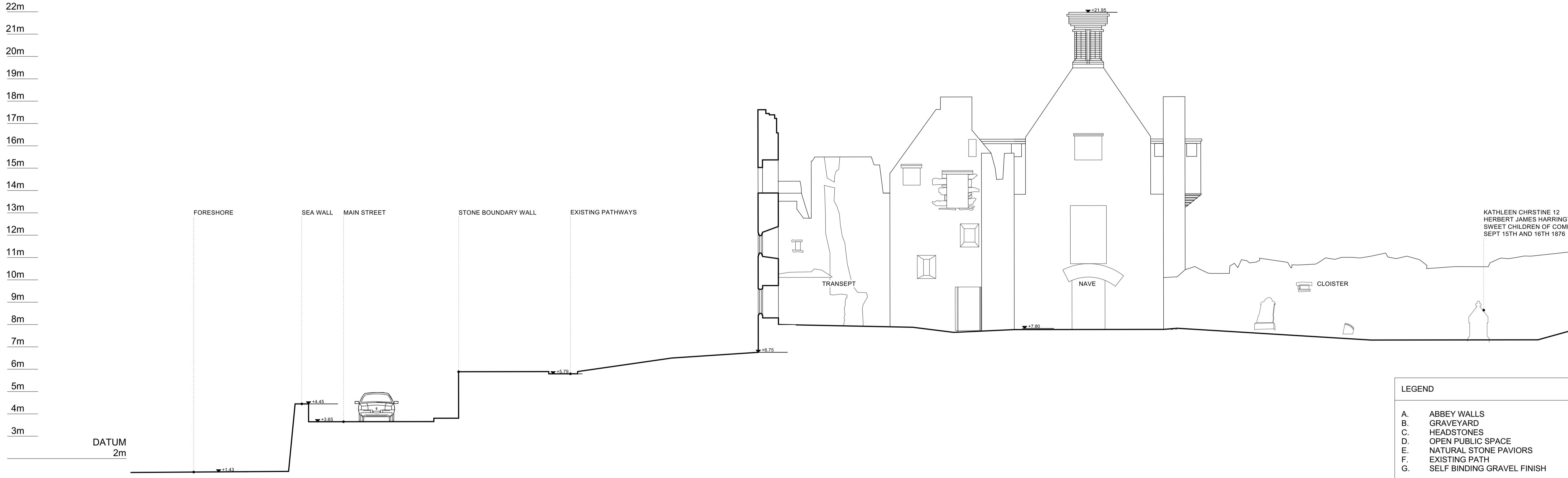

KATHLEEN CHRSTINE 12
HERBERT JAMES HARRINGTON 9
SWEET CHILDREN OF COMMANDER GEORGE T.C. SMITH AND MARY ANNE
SEPT 15TH AND 16TH 1876

- LEGEND**
- A. ABBEY WALLS
 - B. GRAVEYARD
 - C. HEADSTONES
 - D. OPEN PUBLIC SPACE
 - E. NATURAL STONE PAVIORS
 - F. EXISTING PATH
 - G. SELF BINDING GRAVEL FINISH

This drawing has been prepared for the purposes of obtaining Part 8 consent only, for fire certification, tender, compliance with building regulations, construction, or any other purpose, please refer to appropriate labeled drawings.

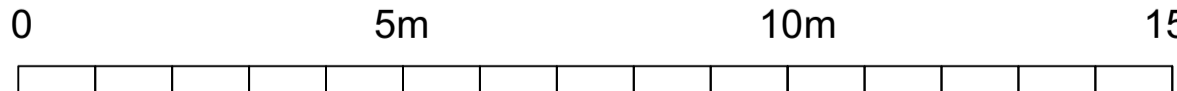

SECTION DD - EXISTING

WORK AREA 03_RATHMULLAN ABBEY
EXISTING SECTIONS



Community Development & Planning Services
Regeneration & Development Team
Three Rivers Centre, Lifford, Co Donegal
Tel:(074)9153900 Fax:(074)9141793 www.donegalcoco.ie
L. Ward, Director of Community Development & Planning Services



LEAD CONSULTANT / ARCHITECT	ROBIN LEE ARCHITECTURE
ARCHITECT	PASPARAKIS FRIEL
CONSERVATION ARCHITECT	DONALD INSALL ASSOCIATES
LANDSCAPE ARCHITECT	BERNARD SEYMOUR LANDSCAPE ARCHITECTS
QUANTITY SURVEYOR	SAMMON
STRUCTURAL ENGINEER	CORA
MECHANICAL & ELECTRICAL ENGINEER	DELAP & WALLER
ECOLOGIST	GREENTRACK
FIRE ENGINEER & ACCESSIBILITY	APEC

Status Key

SL	Survey
SK	Sketch Design
INFO	Information
PL	Planning - Part 8
DD	Detailed Design
FSC	Fire Safety Cert.
DAC	Dis. Acc. Cert.
T	Tender
C	Construction
CPO	CPO
SF	Safety File
O	Other

Rev	Date	Description	Issued by
-	01.11.22	PART 8 APPLICATION	RLA

Project Title:	RATHMULLAN (COMMUNITY & HERITAGE) REGENERATION PROJECT	First Issue Date:	01.11.2022	Status:	PL
Location:	RATHMULLAN, CO. DONEGAL	Drawing No.:	D.RA.012	Revision:	
Drawing Title:	RATHMULLAN ABBEY EXISTING SECTION CC/DD	Drawn By:	RF	Checked By:	SP / RF
Scale:	1:100 / A1	Approved By:	SP	Project No.:	21021



IMPORTANT
 This drawing to be read in conjunction with the ARCHITECT'S DESIGN REPORT for description of the design approach and additional information in support of the proposals illustrated on this page.

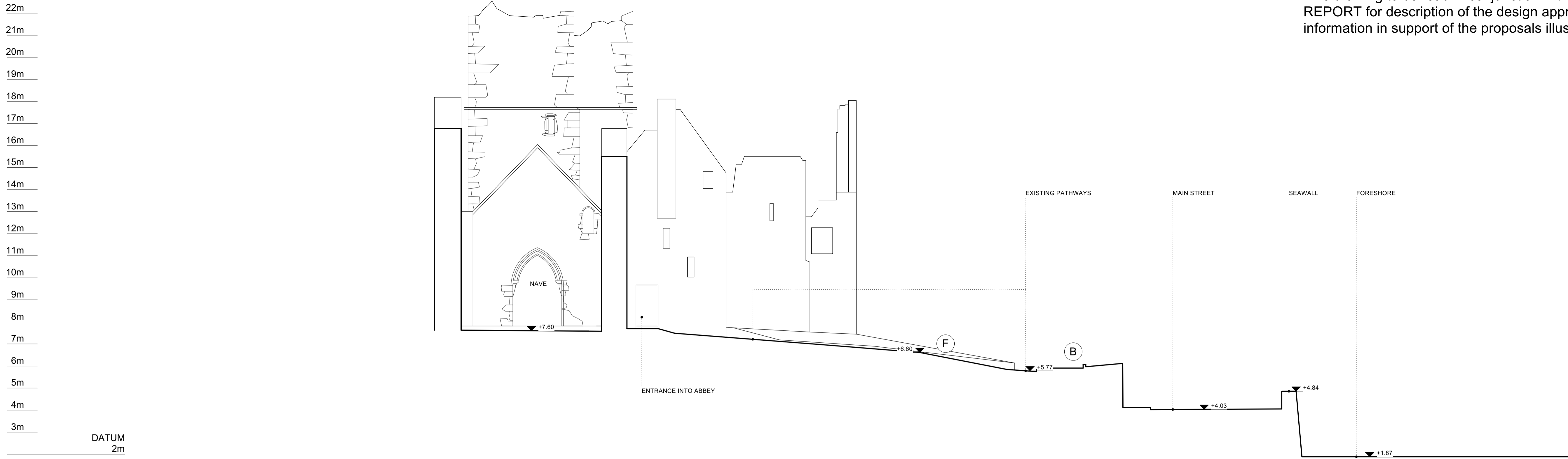

SECTION EE - EXISTING

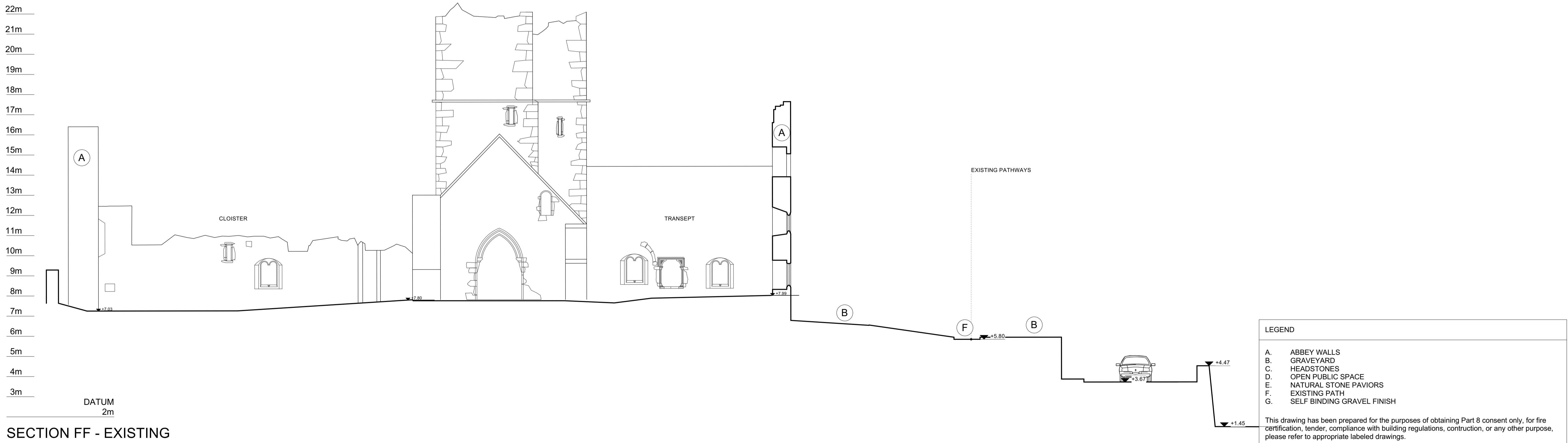

SECTION FF - EXISTING

WORK AREA 03_RATHMULLAN ABBEY
 EXISTING SECTIONS

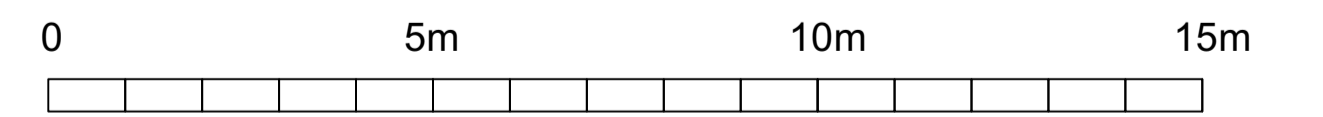

Community Development & Planning Services
 Regeneration & Development Team
 Three Rivers Centre, Lifford, Co Donegal
 Tel:(074)9153900 Fax:(074)9141793 www.donegalcoco.ie
 L. Ward, Director of Community Development & Planning Services



LEAD CONSULTANT / ARCHITECT	ROBIN LEE ARCHITECTURE
ARCHITECT	PASPARAKIS FRIEL
CONSERVATION ARCHITECT	DONALD INSALL ASSOCIATES
LANDSCAPE ARCHITECT	BERNARD SEYMOUR LANDSCAPE ARCHITECTS
QUANTITY SURVEYOR	SAMMON
STRUCTURAL ENGINEER	CORA
MECHANICAL & ELECTRICAL ENGINEER	DELAP & WALLER
ECOLOGIST	GREENTRACK
FIRE ENGINEER & ACCESSIBILITY	A FEC

Status Key

SL	Survey
SK	Sketch Design
INFO	Information
PL	Planning - Part 8
DD	Detailed Design
FSC	Fire Safety Cert.
DAC	Dis. Acc. Cert.
T	Tender
C	Construction
CPO	CPO
SF	Safety File
O	Other

Rev	Date	Description	Issued by
-	01.11.22	PART 8 APPLICATION	RLA

Project Title:	RATHMULLAN (COMMUNITY & HERITAGE) REGENERATION PROJECT	First Issue Date:	01.11.2022	Status:	PL
Location:	RATHMULLAN, CO. DONEGAL	Drawing No.:	D.RA.013	Revision:	
Drawing Title:	RATHMULLAN ABBEY EXISTING SECTION EE/FF	Scale:	1:100 / A1	Drawn By:	RF
		Checked By:	SP / RF	Approved By:	SP
				Project No.:	21021



IMPORTANT
 This drawing to be read in conjunction with the ARCHITECT'S DESIGN REPORT for description of the design approach and additional information in support of the proposals illustrated on this page.

22m
 21m
 20m
 19m
 18m
 17m
 16m
 15m
 14m
 13m
 12m
 11m
 10m
 9m
 8m
 7m
 6m
 5m

DATUM
 4m



SECTION GG - EXISTING

LEGEND	
A.	ABBEY WALLS
B.	GRAVEYARD
C.	HEADSTONES
D.	OPEN PUBLIC SPACE
E.	NATURAL STONE PAVIORS
F.	EXISTING PATH
G.	SELF BINDING GRAVEL FINISH

This drawing has been prepared for the purposes of obtaining Part 8 consent only, for fire certification, tender, compliance with building regulations, construction, or any other purpose, please refer to appropriate labeled drawings.

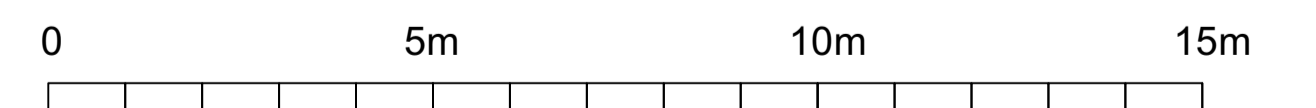

WORK AREA 03_RATHMULLAN ABBEY
 EXISTING SECTIONS



Comhairle Contae
Dhún na nGall
 Donegal County Council

Community Development & Planning Services
 Regeneration & Development Team

Three Rivers Centre, Lifford, Co Donegal

Tel:(074)9153900 Fax:(074)9141793 www.donegalcoco.ie

L. Ward, Director of Community Development & Planning Services



RATHMULLAN
 THE WAY FORWARD

LEAD CONSULTANT / ARCHITECT	ROBIN LEE ARCHITECTURE
ARCHITECT	PASPARAKIS FRIEL
CONSERVATION ARCHITECT	DONALD INSALL ASSOCIATES
LANDSCAPE ARCHITECT	BERNARD SEYMOUR LANDSCAPE ARCHITECTS
QUANTITY SURVEYOR	SAMMON
STRUCTURAL ENGINEER	CORA
MECHANICAL & ELECTRICAL ENGINEER	DELAP & WALLER
ECOLOGIST	GREENTRACK
FIRE ENGINEER & ACCESSIBILITY	APEC

Status Key

SK	Survey
SK	Sketch Design
INFO	Information
PL	Planning - Part 8
DD	Detailed Design
F&C	Fire Safety Cert.
D&A	Dis. Acc. Cert.
T	Tender
C	Construction
CPO	CPO
SF	Safety File
O	Other

Rev	Date	Description	Issued by
-	01.11.22	PART 8 APPLICATION	RLA

Project Title:	RATHMULLAN (COMMUNITY & HERITAGE) REGENERATION PROJECT	First Issue Date:	01.11.2022	Status:	PL
Location:	RATHMULLAN, CO. DONEGAL	Drawing No.:	D.RA.014	Revision:	
Drawing Title:	RATHMULLAN ABBEY EXISTING SECTION GG	Scale:	1:100 / A1	Drawn By:	RF
		Checked By:	SP / RF	Approved By:	SP
		Project No.:	21021		



IMPORTANT
 This drawing to be read in conjunction with the ARCHITECT'S DESIGN REPORT for description of the design approach and additional information in support of the proposals illustrated on this page.

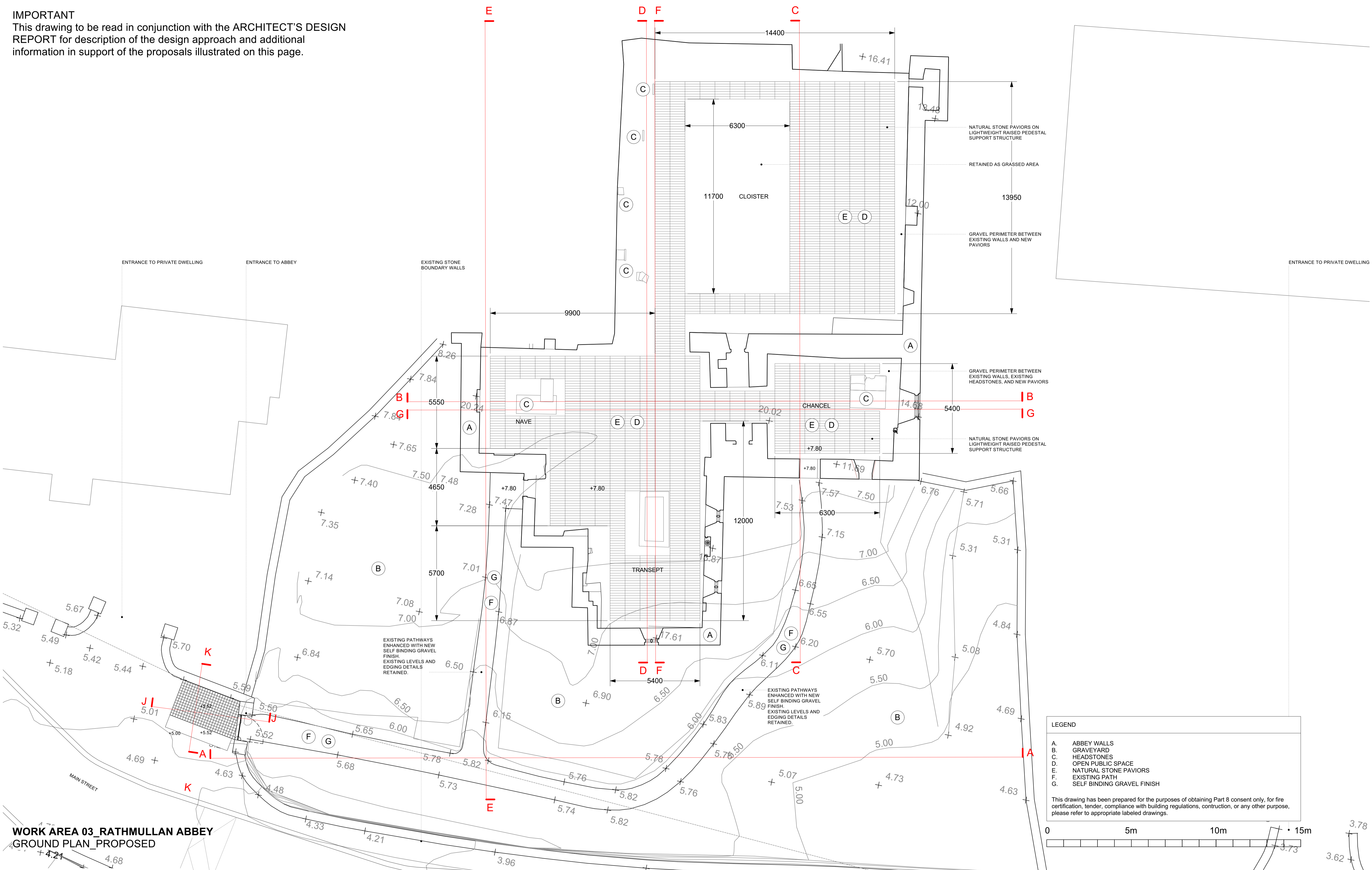

WORK AREA 03_RATHMULLAN ABBEY
GROUND PLAN_PROPOSED

LEGEND

- A. ABBEY WALLS
- B. GRAVEYARD
- C. HEADSTONES
- D. OPEN PUBLIC SPACE
- E. NATURAL STONE PAVIORS
- F. EXISTING PATH
- G. SELF BINDING GRAVEL FINISH

This drawing has been prepared for the purposes of obtaining Part 8 consent only, for fire certification, tender, compliance with building regulations, construction, or any other purpose, please refer to appropriate labeled drawings.

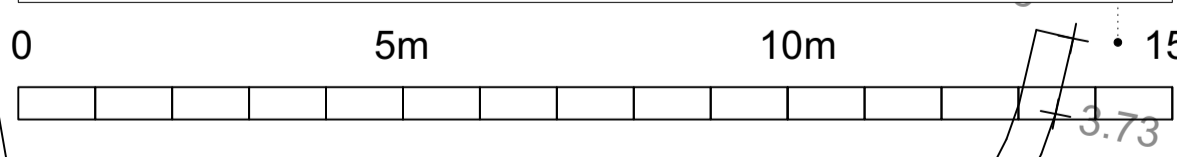

Community Development & Planning Services
 Regeneration & Development Team
 Three Rivers Centre, Lifford, Co Donegal
 Tel:(074)9153900 Fax:(074)9141793 www.donegalcoco.ie
 L. Ward, Director of Community Development & Planning Services



LEAD CONSULTANT / ARCHITECT	ROBIN LEE ARCHITECTURE
ARCHITECT	PASPARAKIS FRIEL
CONSERVATION ARCHITECT	DONALD INSALL ASSOCIATES
LANDSCAPE ARCHITECT	BERNARD SEYMOUR LANDSCAPE ARCHITECTS
QUANTITY SURVEYOR	SAMMON
STRUCTURAL ENGINEER	CORA
MECHANICAL & ELECTRICAL ENGINEER	DELAP & WALLER
ECOLOGIST	GREENTRACK
FIRE ENGINEER & ACCESSIBILITY	APEC

Status Key

SK	Survey
SK	Sketch Design
INFO	Information
PL	Planning - Part 8
DD	Detailed Design
FAC	Fire Safety Cert.
DAC	Dis. Acc. Cert.
T	Tender
C	Construction
CPO	CPO
SF	Safety File
O	Other

Rev	Date	Description	Issued by
-	01.11.22	PART 8 APPLICATION	RLA

Project Title:	RATHMULLAN (COMMUNITY & HERITAGE) REGENERATION PROJECT	First Issue Date:	01.11.2022	Status:	PL
Location:	RATHMULLAN, CO. DONEGAL	Drawing No.:	D.RA.100	Revision:	
Drawing Title:	RATHMULLAN ABBEY GROUND PLAN_PROPOSED	Approved By:	SP	Project No.:	21021
Scale:	1:100 / A1	Checked By:	SP / RF		

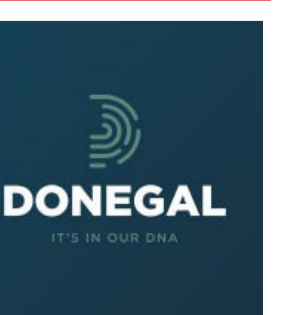

© COPYRIGHT - THIS DRAWING IS PROTECTED BY COPYRIGHT AND IS THE PROPERTY OF DONEGAL COUNTY COUNCIL. IT MAY NOT BE USED, REPRODUCED OR DISCLOSED TO ANYONE WITHOUT THE PRIOR WRITTEN APPROVAL OF DONEGAL COUNTY COUNCIL.

IMPORTANT
 This drawing to be read in conjunction with the ARCHITECT'S DESIGN REPORT for description of the design approach and additional information in support of the proposals illustrated on this page.

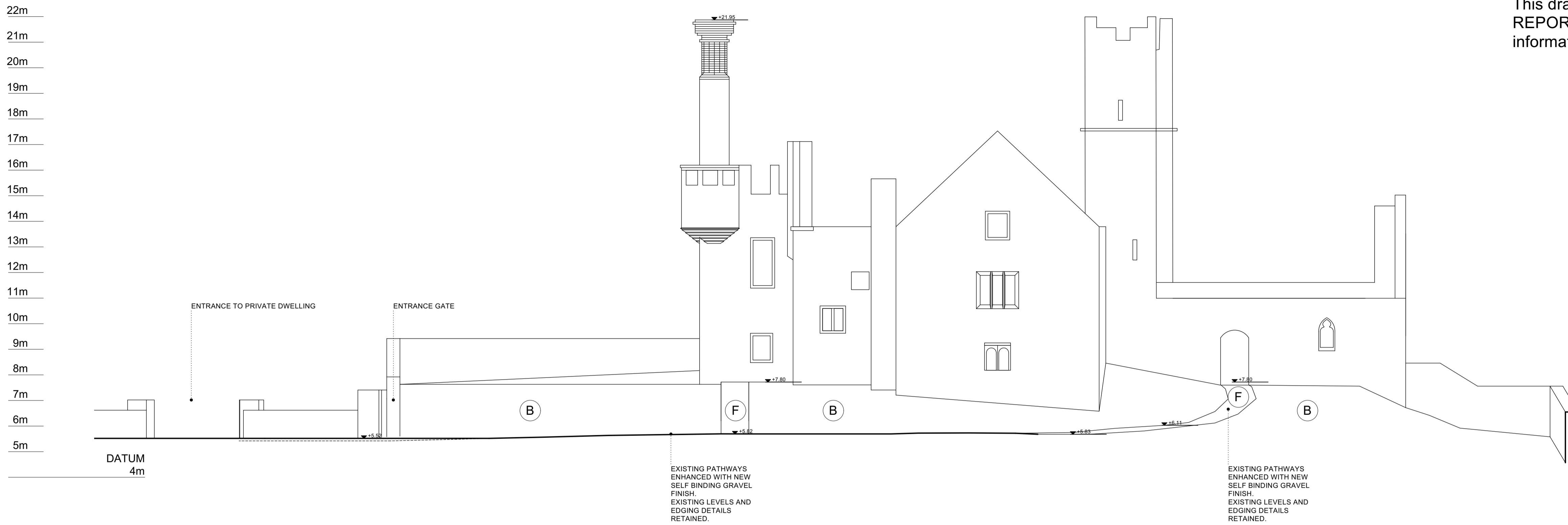

SECTION AA - PROPOSED

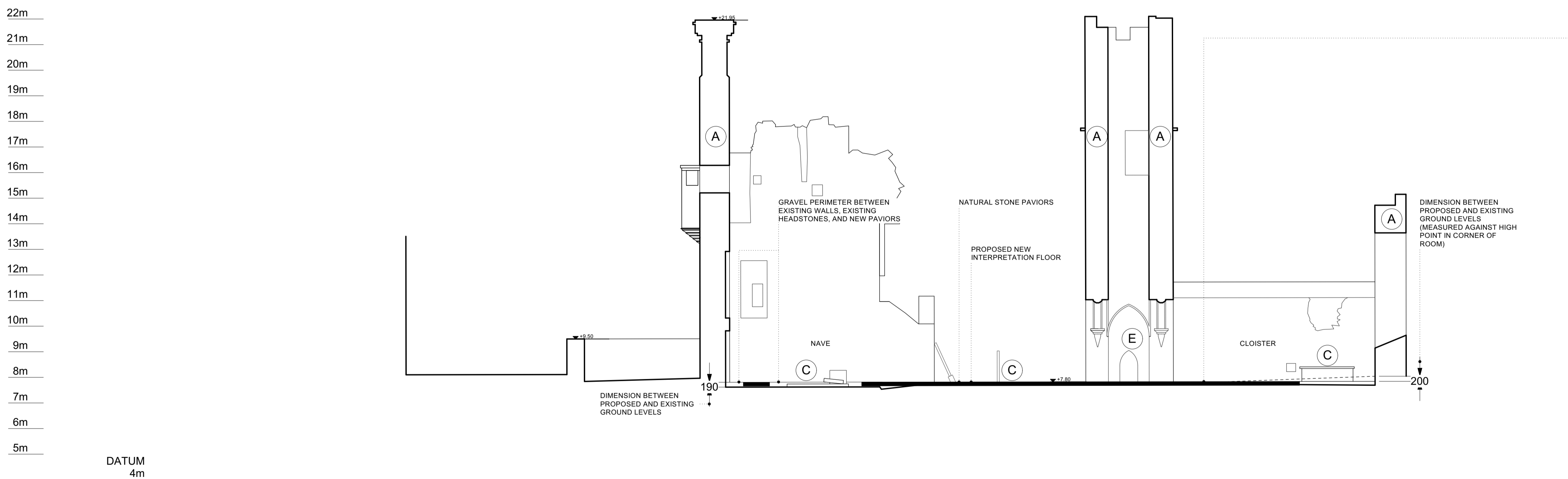

SECTION BB - PROPOSED

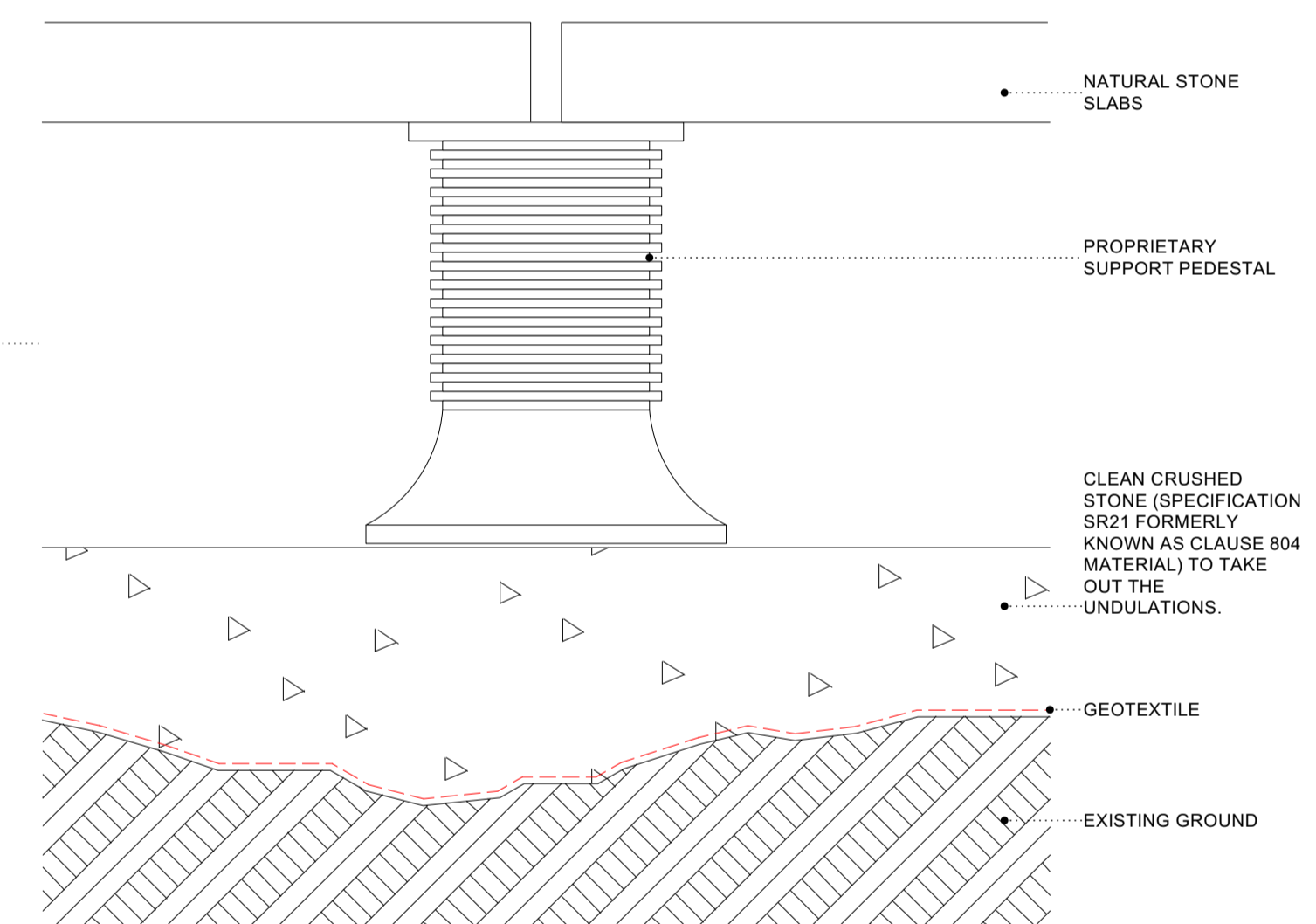

TECHNICAL DETAIL SHOWING FLOOR BUILD UP (NOT TO SCALE)

LEGEND	
A.	ABBEY WALLS
B.	GRAVEYARD
C.	HEADSTONES
D.	OPEN PUBLIC SPACE
E.	NATURAL STONE PAVIORS
F.	EXISTING PATH
G.	SELF BINDING GRAVEL FINISH

This drawing has been prepared for the purposes of obtaining Part 8 consent only, for fire certification, tender, compliance with building regulations, construction, or any other purpose, please refer to appropriate labeled drawings.

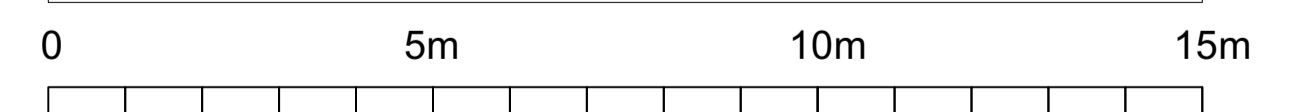

WORK AREA 03. RATHMULLAN ABBEY
 PROPOSED SECTIONS



Community Development & Planning Services
 Regeneration & Development Team
 Three Rivers Centre, Lifford, Co Donegal
 Tel:(074)9153900 Fax:(074)9141793 www.donegalcoco.ie
 L. Ward, Director of Community Development & Planning Services



LEAD CONSULTANT / ARCHITECT	ROBIN LEE ARCHITECTURE
ARCHITECT	PASPARAKIS FRIEL
CONSERVATION ARCHITECT	DONALD INSALL ASSOCIATES
LANDSCAPE ARCHITECT	BERNARD SEYMOUR LANDSCAPE ARCHITECTS
QUANTITY SURVEYOR	SAMMON
STRUCTURAL ENGINEER	CORA
MECHANICAL & ELECTRICAL ENGINEER	DELAP & WALLER
ECOLOGIST	GREENTRACK
FIRE ENGINEER & ACCESSIBILITY	APEC

Status Key	
SK	Survey
SD	Sketch Design
INFO	Information
PL	Planning - Part 8
DD	Detailed Design
FSC	Fire Safety Cert.
DAC	Dis. Acc. Cert.
T	Tender
C	Construction
CPO	CPO
SF	Safety File
O	Other

Rev	Date	Description	Issued by
-	01.11.22	PART 8 APPLICATION	RLA

Project Title:	RATHMULLAN (COMMUNITY & HERITAGE) REGENERATION PROJECT	First Issue Date:	01.11.2022	Status:	PL
Location:	RATHMULLAN, CO. DONEGAL	Drawing No.:	D.RA.200	Revision:	
Drawing Title:	RATHMULLAN ABBEY SECTION AA/BB	Scale:	1:100 / A1	Drawn By:	RF
Checked By:	SP / RF	Approved By:	SP	Project No.:	21021



22m
21m
20m
19m
18m
17m
16m
15m
14m
13m
12m
11m
10m
9m
8m
7m
6m
5m
4m
3m

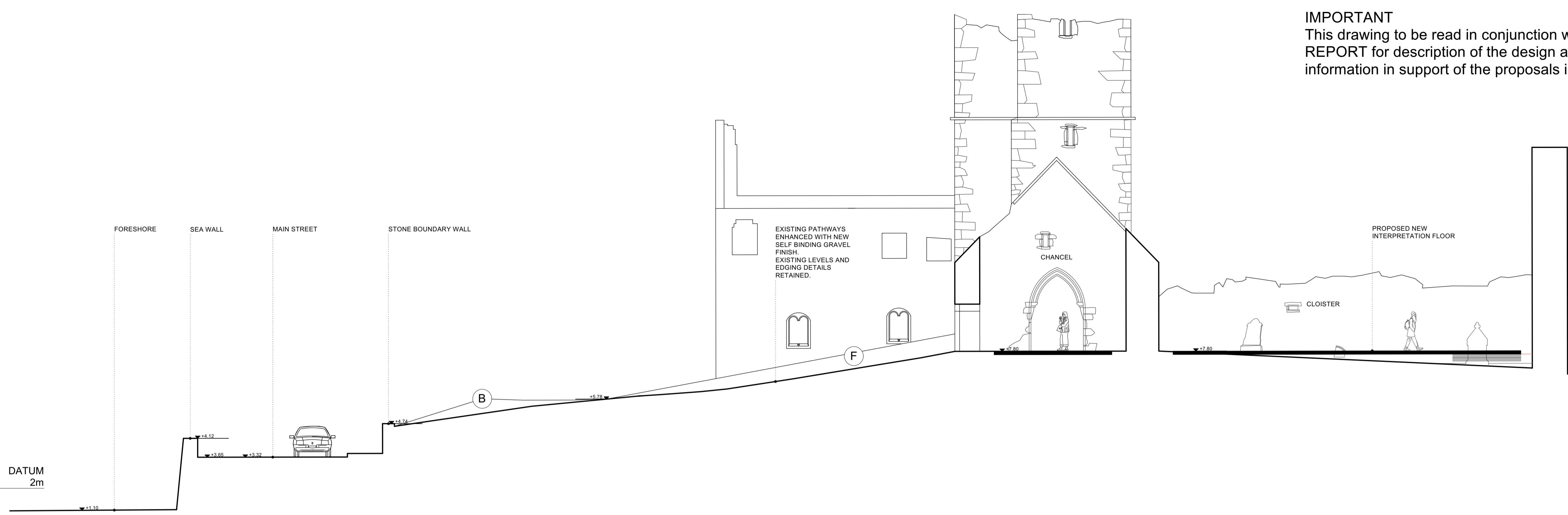

IMPORTANT
This drawing to be read in conjunction with the ARCHITECT'S DESIGN REPORT for description of the design approach and additional information in support of the proposals illustrated on this page.

SECTION CC - PROPOSED

22m
21m
20m
19m
18m
17m
16m
15m
14m
13m
12m
11m
10m
9m
8m
7m
6m
5m
4m
3m

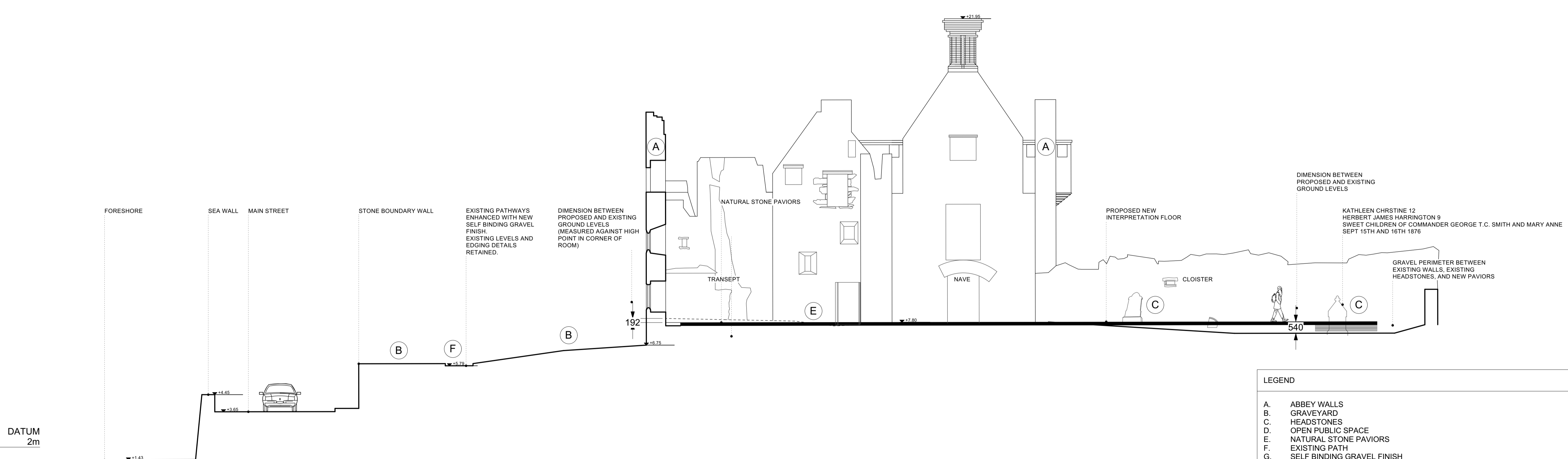

LEGEND

- A. ABBEY WALLS
- B. GRAVEYARD
- C. HEADSTONES
- D. OPEN PUBLIC SPACE
- E. NATURAL STONE PAVIORS
- F. EXISTING PATH
- G. SELF BINDING GRAVEL FINISH

This drawing has been prepared for the purposes of obtaining Part 8 consent only, for fire certification, tender, compliance with building regulations, construction, or any other purpose, please refer to appropriate labeled drawings.

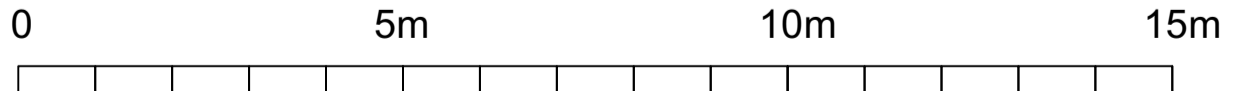

SECTION DD - PROPOSED

WORK AREA 03. RATHMULLAN ABBEY
PROPOSED SECTIONS



Community Development & Planning Services
Regeneration & Development Team
Three Rivers Centre, Lifford, Co Donegal
Tel: (074)9153900 Fax: (074)9141793 www.donegalcoco.ie
L. Ward, Director of Community Development & Planning Services



LEAD CONSULTANT / ARCHITECT	ROBIN LEE ARCHITECTURE
ARCHITECT	PASPARAKIS FRIEL
CONSERVATION ARCHITECT	DONALD INSALL ASSOCIATES
LANDSCAPE ARCHITECT	BERNARD SEYMOUR LANDSCAPE ARCHITECTS
QUANTITY SURVEYOR	SAMMON
STRUCTURAL ENGINEER	CORA
MECHANICAL & ELECTRICAL ENGINEER	DELAP & WALLER
ECOLOGIST	GREENTRACK
FIRE ENGINEER & ACCESSIBILITY	APEC

Status Key

SK	Survey
SK	Sketch Design
INFO	Information
PL	Planning - Part 8
DD	Detailed Design
FSC	Fire Safety Cert.
DAC	Dis. Acc. Cert.
T	Tender
C	Construction
CPO	CPO
SF	Safety File
O	Other

Rev	Date	Description	Issued by
-	01.11.22	PART 8 APPLICATION	RLA

Project Title:	RATHMULLAN (COMMUNITY & HERITAGE) REGENERATION PROJECT	First Issue Date:	01.11.2022	Status:	PL
Location:	RATHMULLAN, CO. DONEGAL	Drawing No.:	D.RA.201	Revision:	
Drawing Title:	RATHMULLAN ABBEY SECTION CC/DD	Checked By:	SP / RF	Approved By:	SP
Scale:	1:100 / A1	Drawn By:	RF	Project No.:	21021

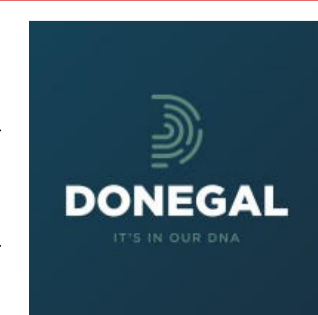

© COPYRIGHT - THIS DRAWING IS PROTECTED BY COPYRIGHT AND IS THE PROPERTY OF DONEGAL COUNTY COUNCIL. IT MAY NOT BE USED, REPRODUCED OR DISCLOSED TO ANYONE WITHOUT THE PRIOR WRITTEN APPROVAL OF DONEGAL COUNTY COUNCIL.

IMPORTANT
 This drawing to be read in conjunction with the ARCHITECT'S DESIGN REPORT for description of the design approach and additional information in support of the proposals illustrated on this page.

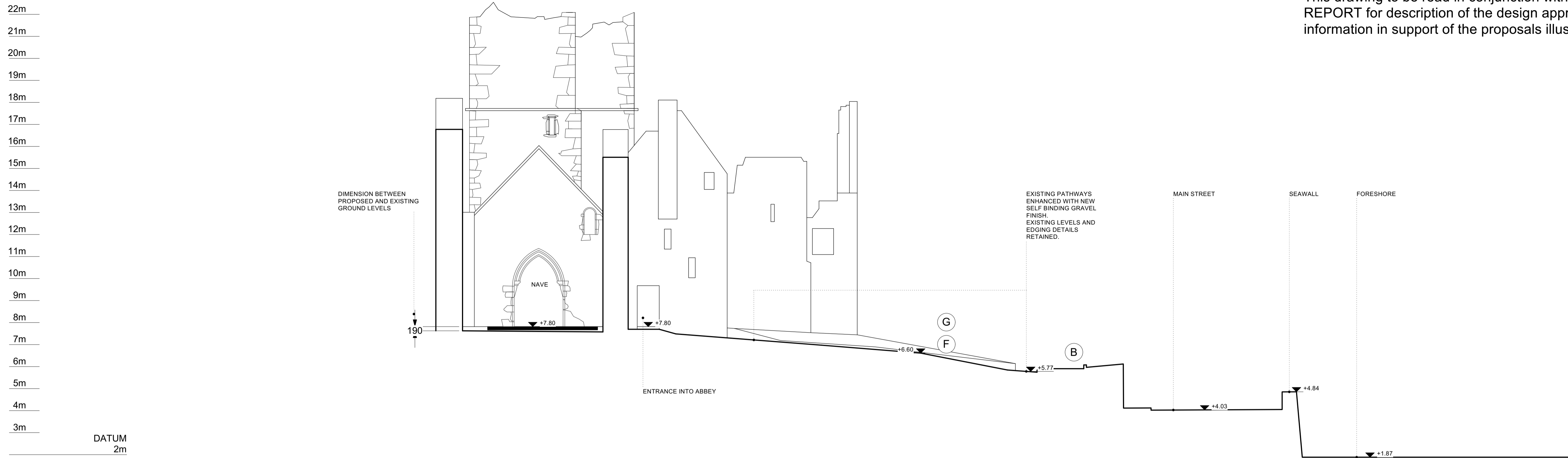

SECTION EE - PROPOSED

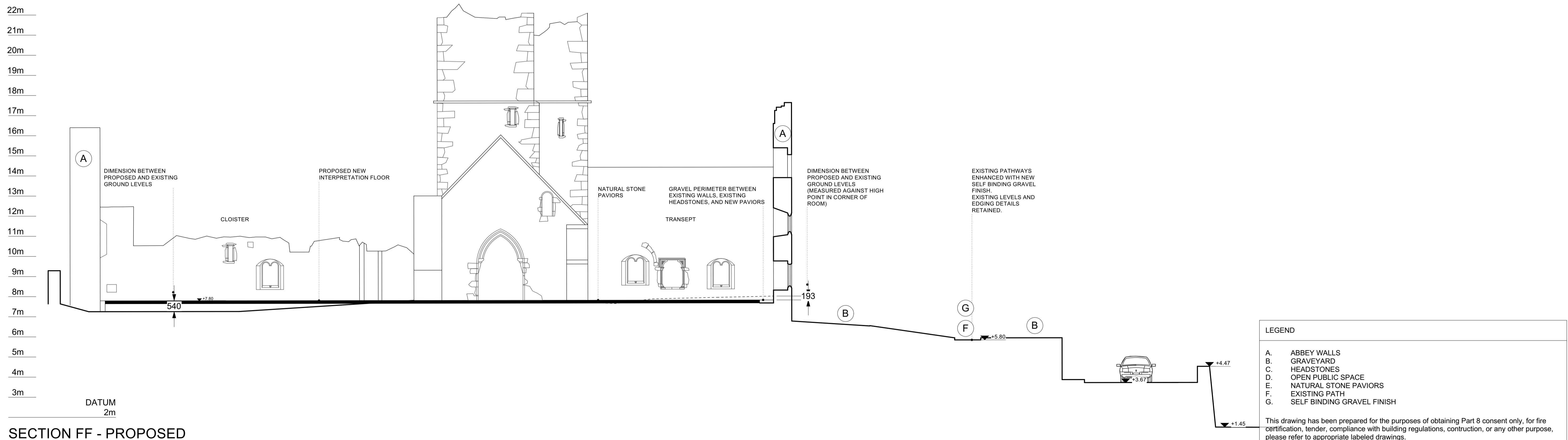

SECTION FF - PROPOSED

WORK AREA 03_RATHMULLAN ABBEY
PROPOSED SECTIONS

LEGEND

- A. ABBEY WALLS
- B. GRAVEYARD
- C. HEADSTONES
- D. OPEN PUBLIC SPACE
- E. NATURAL STONE PAVIORS
- F. EXISTING PATH
- G. SELF BINDING GRAVEL FINISH

This drawing has been prepared for the purposes of obtaining Part 8 consent only, for fire certification, tender, compliance with building regulations, construction, or any other purpose, please refer to appropriate labeled drawings.

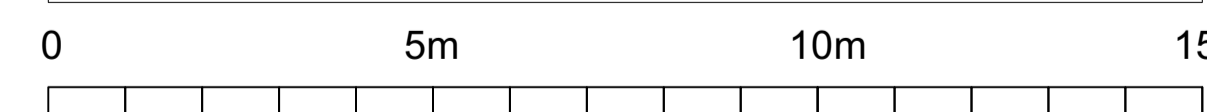

Community Development & Planning Services
Regeneration & Development Team

Three Rivers Centre, Lifford, Co Donegal

Tel:(074)9153900 Fax:(074)9141793 www.donegalcoco.ie

L. Ward, Director of Community Development & Planning Services



LEAD CONSULTANT / ARCHITECT	ROBIN LEE ARCHITECTURE
ARCHITECT	PASPARAKIS FRIEL
CONSERVATION ARCHITECT	DONALD INSALL ASSOCIATES
LANDSCAPE ARCHITECT	BERNARD SEYMOUR LANDSCAPE ARCHITECTS
QUANTITY SURVEYOR	SAMMON
STRUCTURAL ENGINEER	CORA
MECHANICAL & ELECTRICAL ENGINEER	DELAP & WALLER
ECOLOGIST	GREENTRACK
FIRE ENGINEER & ACCESSIBILITY	APEC

Status Key

SL	Survey
SK	Sketch Design
INFO	Information
PL	Planning - Part 8
DD	Detailed Design
FSC	Fire Safety Cert.
DAC	Dis. Acc. Cert.
T	Tender
C	Construction
CPO	CPO
SF	Safety File
O	Other

Rev	Date	Description	Issued by
-	01.11.22	PART 8 APPLICATION	RLA

Project Title:	RATHMULLAN (COMMUNITY & HERITAGE) REGENERATION PROJECT	First Issue Date:	01.11.2022	Status:	PL
Location:	RATHMULLAN, CO. DONEGAL	Drawing No.:	D.RA.202	Revision:	
Drawing Title:	RATHMULLAN ABBEY SECTION EE/FF	Scale:	1:100 / A1	Drawn By:	RF
		Checked By:	SP / RF	Approved By:	SP
		Project No.:	21021		



IMPORTANT
 This drawing to be read in conjunction with the ARCHITECT'S DESIGN REPORT for description of the design approach and additional information in support of the proposals illustrated on this page.

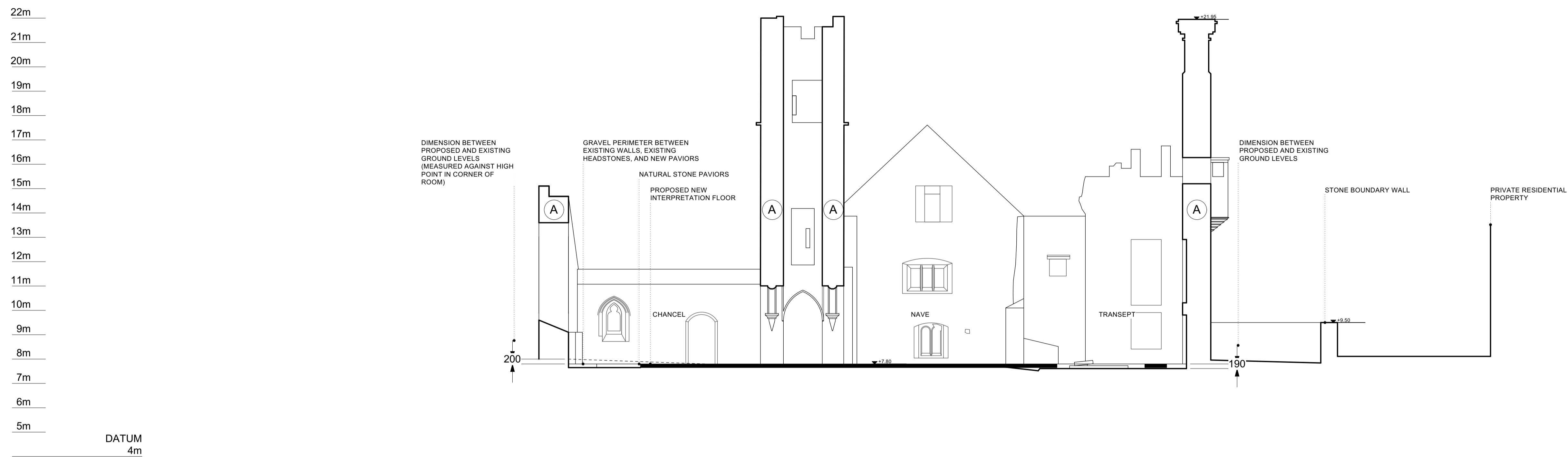

SECTION GG - PROPOSED

LEGEND	
A.	ABBEY WALLS
B.	GRAVEYARD
C.	HEADSTONES
D.	OPEN PUBLIC SPACE
E.	NATURAL STONE PAVIORS
F.	EXISTING PATH
G.	SELF BINDING GRAVEL FINISH

This drawing has been prepared for the purposes of obtaining Part 8 consent only, for fire certification, tender, compliance with building regulations, construction, or any other purpose, please refer to appropriate labeled drawings.

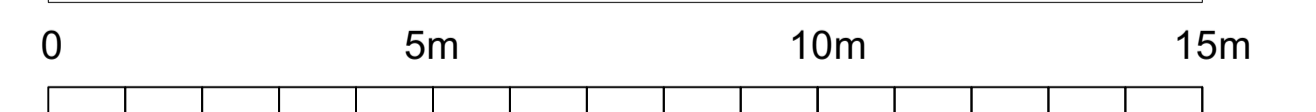

WORK AREA 03_RATHMULLAN ABBEY
 PROPOSED SECTIONS



Comhairle Contae
Dhún na nGall
 Donegal County Council

Community Development & Planning Services
 Regeneration & Development Team

Three Rivers Centre, Lifford, Co Donegal

Tel:(074)9153900 Fax:(074)9141793 www.donegalcoco.ie

L. Ward, Director of Community Development & Planning Services



RATHMULLAN
 THE WAY FORWARD

LEAD CONSULTANT / ARCHITECT	ROBIN LEE ARCHITECTURE
ARCHITECT	PASPARAKIS FRIEL
CONSERVATION ARCHITECT	DONALD INSALL ASSOCIATES
LANDSCAPE ARCHITECT	BERNARD SEYMOUR LANDSCAPE ARCHITECTS
QUANTITY SURVEYOR	SAMMON
STRUCTURAL ENGINEER	CORA
MECHANICAL & ELECTRICAL ENGINEER	DELAP & WALLER
ECOLOGIST	GREENTRACK
FIRE ENGINEER & ACCESSIBILITY	APEC

Status Key

SL	Survey
SK	Sketch Design
INFO	Information
PL	Planning - Part 8
DD	Detailed Design
F&C	Fire Safety Cert.
D&C	Dis. Acc. Cert.
T	Tender
C	Construction
CPO	CPO
SF	Safety File
O	Other

Rev	Date	Description	Issued by
-	01.11.22	PART 8 APPLICATION	RLA

Project Title:	RATHMULLAN (COMMUNITY & HERITAGE) REGENERATION PROJECT	First Issue Date:	01.11.2022	Status:	PL
Location:	RATHMULLAN, CO. DONEGAL	Drawing No.:	D.RA.203	Revision:	
Drawing Title:	RATHMULLAN ABBEY SECTION GG	Project No.:	21021		
Scale:	1:100 / A1	Drawn By:	RF	Checked By:	SP / RF
		Approved By:	SP		



IMPORTANT
 This drawing to be read in conjunction with the ARCHITECT'S DESIGN REPORT for description of the design approach and additional information in support of the proposals illustrated on this page.

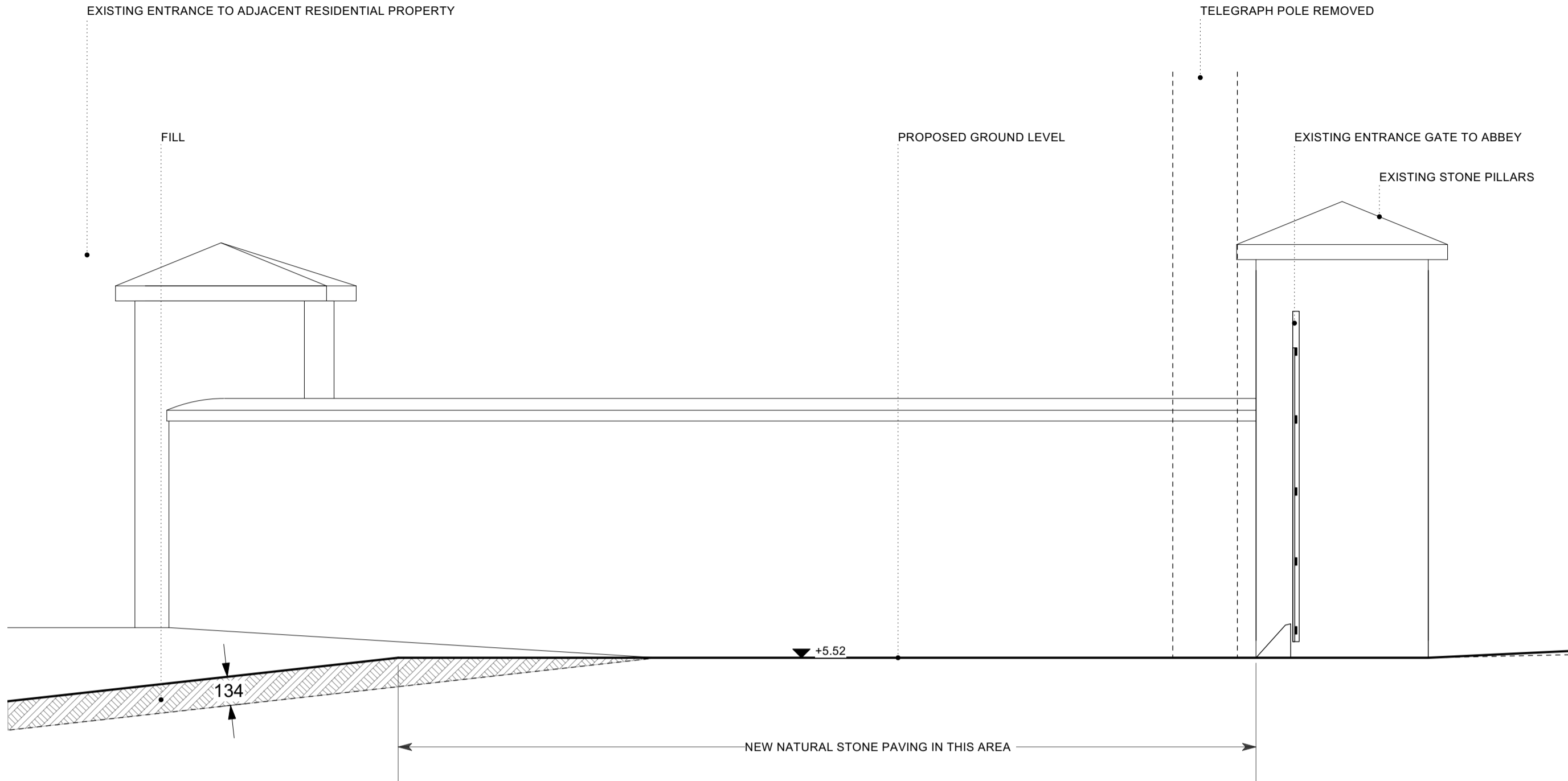

SECTION JJ - PROPOSED

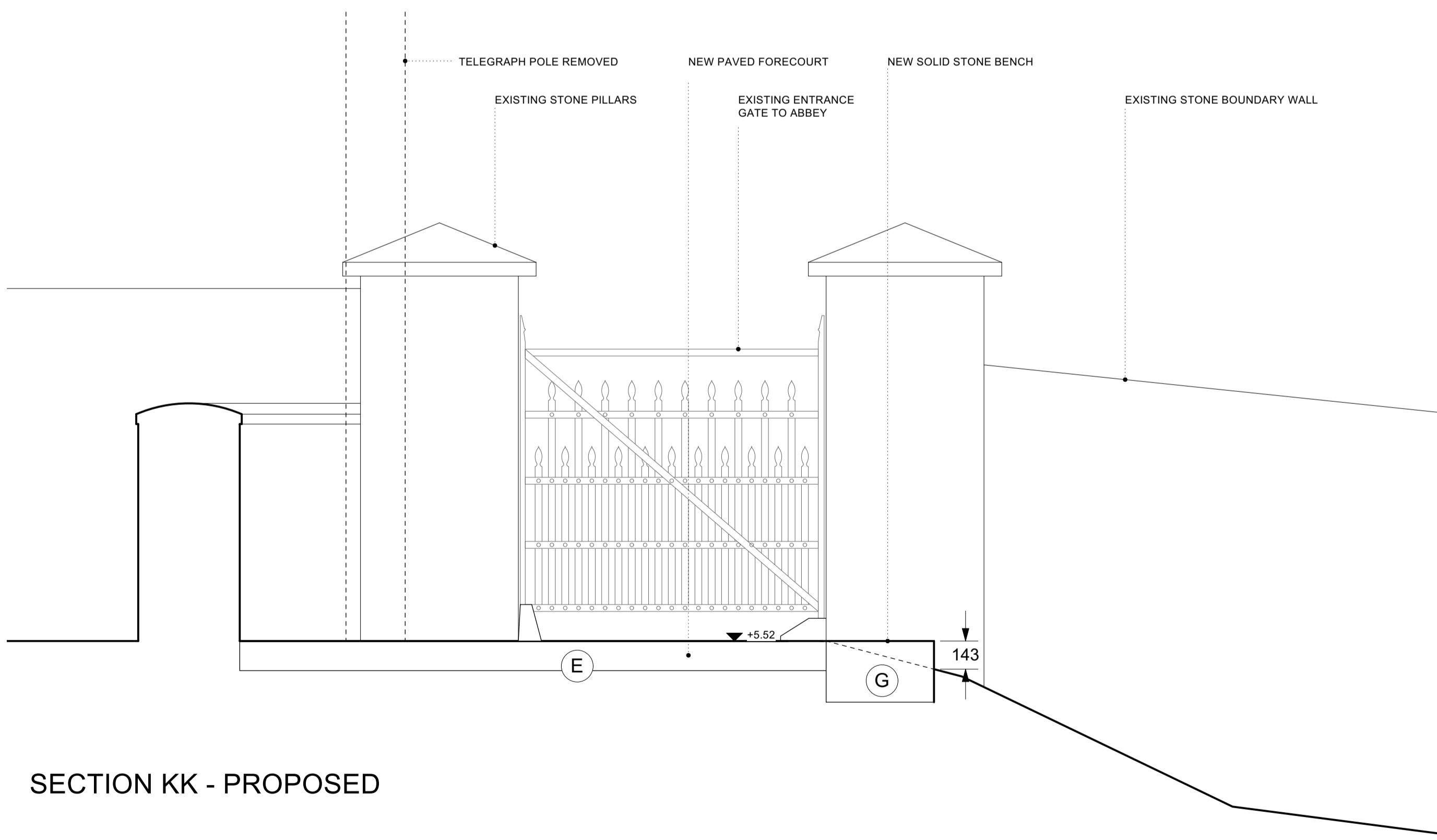

SECTION KK - PROPOSED

WORK AREA 03_RATHMULLAN ABBEY
 PROPOSED SECTIONS

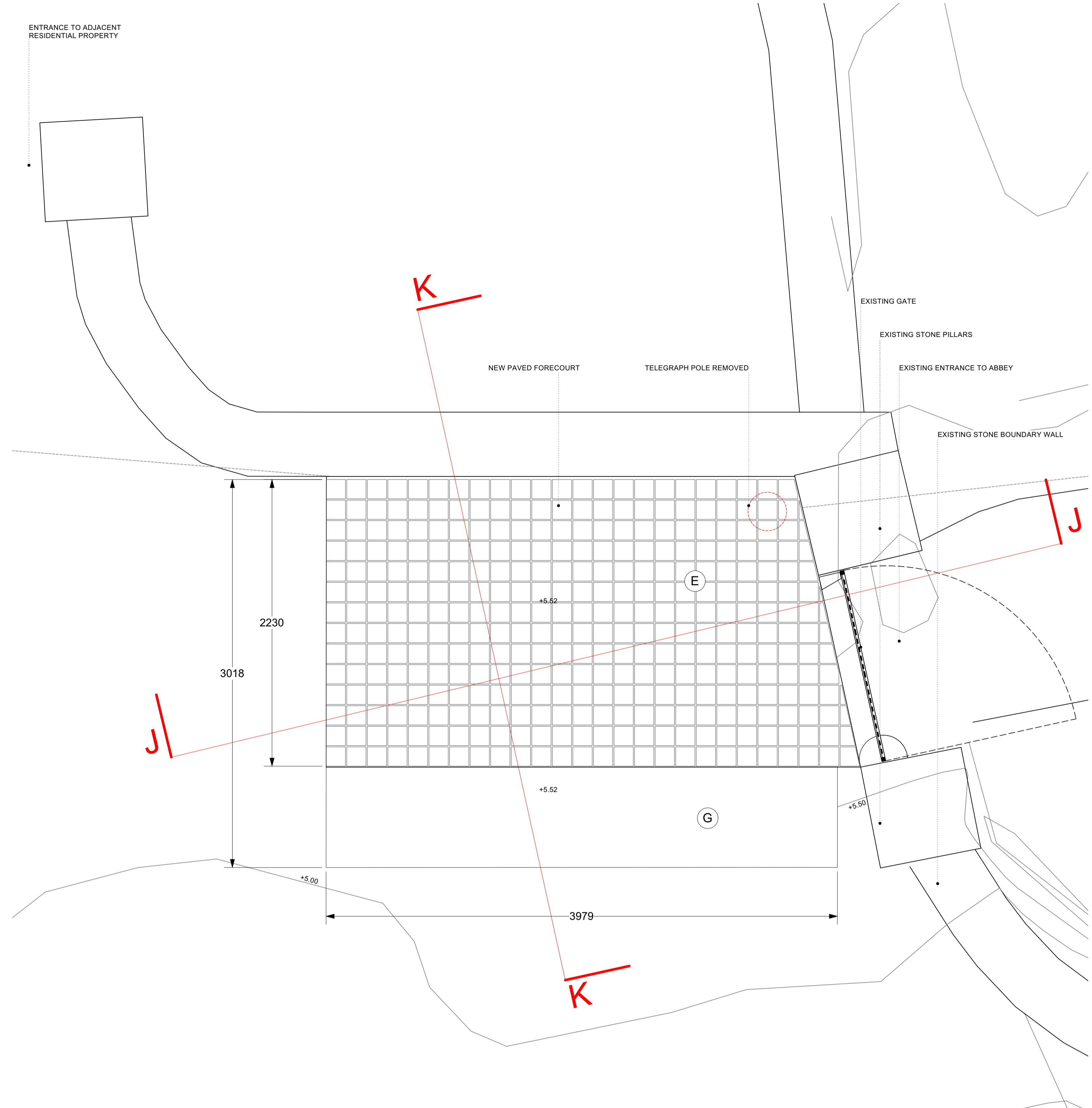

PLAN - ENTRANCE GATE

LEGEND

- A. ABBEY WALLS
- B. GRAVEYARD
- C. HEADSTONES
- D. OPEN PUBLIC SPACE
- E. NATURAL STONE PAVIORS
- F. EXISTING PATH
- G. SOLID STONE BENCH
- CUT/FILL

This drawing has been prepared for the purposes of obtaining Part 8 consent only, for fire certification, tender, compliance with building regulations, construction, or any other purpose, please refer to appropriate labeled drawings.

0 1m 2m 3m



Community Development & Planning Services
 Regeneration & Development Team
 Three Rivers Centre, Lifford, Co Donegal
 Tel:(074)9153900 Fax:(074)9141793 www.donegalcoco.ie
 L. Ward, Director of Community Development & Planning Services



LEAD CONSULTANT / ARCHITECT	ROBIN LEE ARCHITECTURE
ARCHITECT	PASPARAKIS FRIEL
CONSERVATION ARCHITECT	DONALD INSALL ASSOCIATES
LANDSCAPE ARCHITECT	BERNARD SEYMOUR LANDSCAPE ARCHITECTS
QUANTITY SURVEYOR	SAMMON
STRUCTURAL ENGINEER	CORA
MECHANICAL & ELECTRICAL ENGINEER	DELAP & WALLER
ECOLOGIST	GREENTRACK
FIRE ENGINEER & ACCESSIBILITY	A FEC

Status Key

SL	Survey
SK	Sketch Design
INFO	Information
PL	Planning - Part 8
DD	Detailed Design
FSC	Fire Safety Cert.
DAC	Dis. Acc. Cert.
T	Tender
C	Construction
CPO	CPO
SF	Safety File
O	Other

Rev	Date	Description	Issued by
-	01.11.22	PART 8 APPLICATION	RLA

Project Title:	RATHMULLAN (COMMUNITY & HERITAGE) REGENERATION PROJECT	First Issue Date:	01.11.2022	Status:	PL
Location:	RATHMULLAN, CO. DONEGAL	Drawing No.:	D.RA.204	Revision:	
Drawing Title:	RATHMULLAN ABBEY SECTION JJ & KK	Scale:	1:20 / A1	Drawn By:	RF
Checked By:	SP / RF	Approved By:	SP	Project No.:	21021

